

Table of Contents

Introduction	Page 2, 3
--------------------	-----------

Emergency Lighting

CC RS Series	4, 5
CC TS Series	6
CC LS Series	7
CC JS Series	8, 9
CC NV Series	10
CC ILS Series	11
CC KS Series	12

Remote Heads

CC EF28 & CC EF150 Series	13
---------------------------------	----

Exit Signs

X10 Series	14, 15
Prestige™ Series	16, 17

Wiring Size Guide	18
-------------------------	----

Popular Options	19
-----------------------	----

Advanced Diagnostics	20
----------------------------	----

Lamp Chart	Inside Back Cover
------------------	-------------------



Setting the standard

Combining high performance, reliability, quality and cost efficiency, the products in this brochure are manufactured to meet, and in some cases surpass, the highest standards—your standards.

Up to code

In response to the decision taken by the City of Chicago's Department of Buildings, Electrical Division, to use UL-Approved products for "City of Chicago Environmental Airspaces" (CCEA), Emergi-Lite has gained this recognition for selected recessed equipment. Look for products bearing the CCEA logo. In addition to meeting City of Chicago's code requirements, all Emergi-Lite products meet or exceed the requirements of UL 924, NFPA 101, Life Safety Code, NEC and ICC standards.

Emergi-Lite is proud to present a complete range of City of Chicago-approved life safety equipment for industrial, commercial and institutional environments.

Rigid control standards

From product design and manufacturing through to final installation, all units are built to exacting standards to meet style, performance, reliability, ease-of-installation and cost requirements.

A tradition of innovation

Since 1978, Emergi-Lite has been a pioneer in the development and manufacture of reliable, high quality life safety equipment. We look forward to continuing this tradition into the future.



CC RS Series

EMERGI-LITE

6- and 12-Volt Decorator Recessed Emergency Lighting

The CC RS Series is architecturally designed for low profile, unobtrusive use in either ceilings or walls and complements any decor. Models are supplied standard with two EF28 metal lamp heads.

Listed to UL 924 Standards

Complies with NEC, Life Safety Code and OSHA. UL Approved for use in "City of Chicago Environmental Airspaces" (CCEA).

Sealed Maintenance-Free Batteries

- Nickel Cadmium
- Long Life Lead
- Lead Calcium

Mounting

Unit supplied with adjustable bar hangers for grid ceilings or can be framed into studs/joists.

Outline and Dimensions

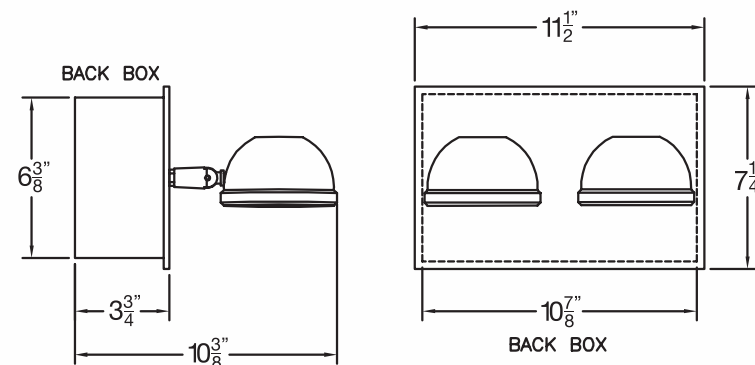

Dimensions are approximate and subject to change.

Diagnostic / Self-Test Feature (optional)

Diagnostic / Self-Test circuitry is optional on all models. This circuitry is programmed to ensure the equipment's readiness and reliability by continuously monitoring every critical function of the unit. If a fault is detected, audible visual indicators isolate the fault, eliminating trouble shooting time. The self-test feature will simulate a power loss for 30 seconds every 30 days with the exception being a full 90-minute test annually.

Options & Accessories

Options (add suffix)

Ammeter or Voltmeter
(Choose only one)-A* or -V*
Advanced Diagnostics-AD
Advanced Diagnostics, Non-Audible-ADNA
Time Delay
(Specify 5, 10 or 15 minutes)-TD**
Non-Standard Input VoltageSpecify
(add prefix)
Black Housing and Heads-B-

Accessories (order as a separate item)

Wire GuardWG6
27" Adjustable Bar HangersBHRS***

* Not available with Diagnostics options.
** Not required when using the AD option.
*** For replacement purposes only.
Units are supplied standard with bar hangers.



CCEA
APPROVED



Unit Rating Chart

Furnished standard with two EF28 12-watt Sealed Beam Halogen Lamps.

Sealed Maintenance-Free Battery Types	D.C. Volt	Model Number EF28 Lamp Heads	*Watts to 87-1/2% of Rated Battery Voltage			
			1-1/2 hrs.	2 hrs.	3 hrs.	4 hrs.
Nickel Cadmium	▲ 6	CCRSC25-2	25	18	12	9
	▲ 12	CC12RSC36-2	36	21	15	12
Long Life Lead	▲ 6	CCRSE27-2	27	19	14	10
	▲ 6	CCRSE36-2	36	24	17	13
	▲ 12	CC12RSE36-2	36	24	17	13
Lead Calcium	▲ 6	CCRSM27-2	27	18	14	10
	▲ 6	CCRSM36-2	36	25	20	14
	▲ 12	CC12RSM36-2	36	25	20	14

*National Electrical Code Specification ▲ = Advanced Diagnostics Available

How to Order

Example only. For standard units without options, order Series, Battery, Watts and Heads only.								Options are added to units by listing suffix at end of model #.	
CC	12	RS	M	36	2	—	(HJ)*	AD	
City of Chicago Approved Unit	Battery Voltage Blank = 6 VDC 12 = 12 VDC	Series	Battery Type C = Nickel Cadmium E = Long Life Lead M = Lead Calcium	Watts for 90 min. (See Unit Rating Chart)	Heads 0 = No Heads 1 = One Head 2 = Two Heads		Lamp Type ¹ Blank = EF28 Heads ² (MG) = EF150 Heads ³ with 12V, 12W MR16 EF150 Heads (HJ) = EF28 Heads with 12V, 12W Bi-Pin	See Options Chart.	
* Do not exceed unit rating in voltage or capacity. 1= See lamp chart on Inside Back Cover for alternate lamps. 2= 6- or 12-volt units supplied with 12-watt sealed beam halogen lamp, PAR36 3= 12-volt units only. MR16 lamps are available in 12-watts for this series.									



Standard Features

- Reliability**
The CC TS Series comes complete with a 3-year full warranty (excluding lamps and pilot lights).
- Unit Data**
Constructed of 18 gauge steel with an off-white, baked enamel finish. Furnished standard with two EF28 heads, optional heads include EF150 heads with MR16 lamps (see How to Order). Designed for T-Bar grid ceilings.
Unit and lamp head color is true-white when MR16 lamps are ordered.
- PulsePlus Charger**
PulsePlus circuitry offers 120/277-volt input 60 Hz., 0.3 Amp (other inputs available), fused output circuit(s), dual diagnostic indicator lights, temperature compensated charger, sealed relay, low voltage battery disconnect, brownout protection and lockout (automatic battery connect).



Outline and Dimensions

Cabinet Size	Dimensions (in.)
A	3-1/4
B	5-5/8

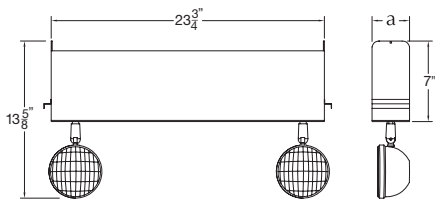

Dimensions are approximate and subject to change.

CC TS Series

6- and 12-Volt T-Bar Unit

The CC TS Series is architecturally designed for unobtrusive use in T-Bar ceilings. The off-white, fully recessed housing harmonizes with ceiling designs.

Listed to UL 924 Standards

Complies with NEC, Life Safety Code and OSHA. UL approved for use in "City of Chicago Environmental Airspaces" (CCEA).

Sealed Maintenance-Free Batteries

- Nickel Cadmium
- Long Life Lead
- Lead Calcium

Options & Accessories

Options (add suffix)

Ammeter or Voltmeter (choose only one) -A* or -V*
Advanced Diagnostics -AD
Advanced Diagnostics, Non-Audible -ADNA
Lamp Disconnect Switch -LD
Time Delay (specify 5, 10 or 15 minutes) -TD**
Non-Standard Input Voltage Specify
Automatic Unit Cycler -AUC**

(add prefix)

Black Housing and Heads B-

* Not available with Diagnostics options.
** Not required when using the AD option.

Unit Rating Chart

Sealed Maintenance-Free Battery Types		D.C. Volt	Model Number EF28 Lamp Heads	*Watts to 87-1/2% of Rated Battery Voltage				Cabinet Size
				1-1/2 hrs.	2 hrs.	3 hrs.	4 hrs.	
Nickel Cadmium	▲	6	CCTSC25-2	25	18	12	9	A
	▲	12	CC12TSC36-2	36	21	15	12	A
	▲	12	CC12TSC50-2	50	36	25	18	A
Long Life Lead	▲	6	CCTSE27-2	27	19	14	10	A
	▲	6	CCTSE36-2	36	24	17	13	A
	▲	6	CCTSE50-2	54	37	28	21	A
	▲	6	CC12TSE110-2	110	74	57	43	B
	▲	12	CC12TSE36-2	36	24	17	13	A
	▲	12	CC12TSE54-2	54	37	28	21	A
Lead Calcium	▲	12	CC12TSE72-2	72	62	43	33	A
	▲	12	CC12TSE110-2	110	74	57	43	A
	▲	6	CCTSM27-2	27	18	14	10	A
	▲	6	CCTSM36-2	36	25	20	14	A
	▲	6	CCTSM54-2	54	37	28	21	A
	▲	6	CCTSM110-2	110	72	56	40	B
	▲	12	CC12TSM36-2	36	25	20	14	A
	▲	12	CC12TSM54-2	54	37	28	21	A
	▲	12	CC12TSM110-2	110	72	56	40	B

*National Electrical Code Specification ▲ = Advanced Diagnostics Available

How to Order

Example only.
For standard units without options, order Series, Battery, Watts and Heads only.

CC	12	TS	M	36	2	(HJ)*	AD
City of Chicago Approved Unit	Battery Voltage Blank = 6VDC 12 = 12VDC	Series	Battery Type C = Nickel Cadmium E = Long Life Lead M = Lead Calcium	Watts for 90 min. (See Unit Rating Chart)	Heads 0 = No Heads 1 = One Head 2 = Two Heads 3 = Three Heads	Lamp Type ¹ (HJ) = 12V, 12W Bi-Pin Halogen, EF28 Heads (MA) = 12V, 20W, MR16, EF150 Heads ³ (MB) = 12V, 35W, MR16, EF150 Heads ³ (MC) = 12V, 50W, MR16, EF150 Heads ³ (MG) = 12V, 12W, MR16, EF150 Heads	See Options Chart.
* Do not exceed unit rating in voltage or capacity. 1= See lamp chart on Inside Back Cover for alternate lamps. 2= 6- or 12-volt units supplied with 12-watt sealed beam halogen lamp, PAR36 3= 12-volt units only.							

Options are added to units by listing suffix at end of model #.

CC LS Series

6- and 12-Volt Steel Enclosure

The CC LS Series is offered where an attractive, conventional emergency lighting unit is required. This series offers a wide selection of battery capacities for use when remote fixtures are desired, or when extended run times are required.

Listed to UL 924 Standards

Complies with NEC, Life Safety Code and OSHA.

Sealed Maintenance-Free Batteries

- Nickel Cadmium
- Long Life Lead
- Lead Calcium

Options & Accessories

Options (add suffix)

Ammeter or Voltmeter ("A" cabinet units, choose only one) -A* or -V*
Advanced Diagnostics -AD
Advanced Diagnostics, Non-Audible -ADNA
Lamp Disconnect Switch -LD
Time Delay (specify 5, 10 or 15 minutes) -TD**
Non-Standard Input Voltage Specify
Cord Set - 120-Volt -CP
Special-Voltage CP (specify plug type) -XP***
Automatic Unit Cycler -AUC**

(add prefix)

Black Housing and Heads B-

Accessories (order as a separate item)

Mounting Bracket (Cabinet A) B1
Mounting Bracket (Cabinet B) B2
Mounting Shelves (Cabinet B) MP3
Mounting Shelves (Cabinet C) MP6
Wire Guard (Cabinet A) WG2
Wire Guard (Cabinet B & Cabinet C) WG3

* Not available with Diagnostics options.
** Not required with the AD option.
*** Standard cord is 3 ft. Custom lengths available.

Unit Rating Chart

Furnished standard with two EF28 12-watt Sealed Beam Halogen Lamps.

Sealed Maintenance-Free Battery Types	D.C. Volt	Model Number	*Watts to 87-1/2% of Rated Battery Voltage				# of Load Fuses	Cabinet Size
			1-1/2 hrs.	2 hrs.	3 hrs.	4 hrs.		
Nickel Cadmium	▲	6	CCLSC25-2	25	18	9	-	A
	▲	12	CCLSC36-2	36	21	12	6	A
	▲	12	CC12LSC50-2	50	36	18	10	A
Long Life Lead	▲	6	CCLSE27-2	27	16	10	5	A
	▲	6	CCLSE36-2	36	24	13	7	A
	▲	6	CCLSE54-2	54	36	20	11	A
	▲	6	CCLSE80-2	80	65	35	19	B
	▲	6	CCLSE110-2	110	74	43	21	B
	▲	12	CC12LSE36-2	36	24	13	7	A
Lead Calcium	▲	12	CC12LSE54-2	54	37	21	10	A
	▲	12	CC12LSE72-2	72	48	26	14	B
	▲	12	CC12LSE110-2	110	74	43	21	B
	▲	6	CCLSM27-2	27	18	10	6	A
	▲	6	CCLSM36-2	36	25	14	7	A
	▲	6	CCLSM54-2	54	37	21	12	A
	▲	6	CCLSM81-2	81	54	36	18	B
	▲	6	CCLSM110-2	110	72	40	24	B
	▲	12	CC12LSM36-2	36	25	14	7	A
	▲	12	CC12LSM54-2	54	37	21	12	A
	▲	12	CC12LSM110-2	110	72	40	24	B
	▲	12	CC12LSM162-2	162	108	60	36	C

*National Electrical Code Specification ▲ = Advanced Diagnostics Available

How to Order

Example only.
For standard units without options, order Series, Battery, Watts and Heads only.

Options are added to units by listing suffix at end of model #.

CC	12	LS	M	36	2	(HJ)*	AD
City of Chicago Approved Unit	Battery Voltage Blank = 6VDC 12 = 12VDC	Series	Battery Type C = Nickel Cadmium E = Long Life Lead M = Lead Calcium	Watts for 90 min. (See Unit Rating Chart)	Heads 0 = No Heads 1 = One Head 2 = Two Heads 3 = Three Heads	Lamp Type ¹ Blank = 12V, 12W Sealed Beam Halogen, PAR36 ² (HJ) = 12V, 12W Bi-Pin Halogen, EF28 Heads (MA) = 12V, 20W, MR16, EF150 Heads ³ (MB) = 12V, 35W, MR16, EF150 Heads ³ (MC) = 12V, 50W, MR16, EF150 Heads ³ (MG) = 12V, 12W, MR16, EF150 Heads ³	See Options Chart.
* Do not exceed unit rating in voltage or capacity. 1= See lamp chart on Inside Back Cover for alternate lamps. 2= 6- or 12-volt units supplied with 12-watt sealed beam halogen lamp, PAR36 3= 12-volt units only.							

Standard Features

- Reliability**
The CC LS Series comes complete with a 3-year full warranty (excluding lamps and pilot lights).
- Unit Data**
Constructed of 20 gauge steel with an off-white, baked enamel finish. Removable front panel. Furnished standard with two EF28 heads with one 12-watt lamp per head. Optional one or three heads available (see How to Order).
Unit and lamp head color is true-white when MR16 lamps are ordered.
- PulsePlus Charger**
PulsePlus circuitry offers 120/277-volt input 60 Hz., 0.3 Amp (other inputs available), fused output circuit(s), dual diagnostic indicator lights, temperature compensation, sealed relay, low voltage battery disconnect, brownout protection and lockout (automatic battery connect).



Outline and Dimensions

Cabinet Size	Dimensions (in.)			
	a	b	c	d
A	17-1/8	13	3-5/8	10-1/2
B	17-1/8	16-1/8	5-1/2	10-1/2
C	19	16-1/2	7-1/4	12-1/4

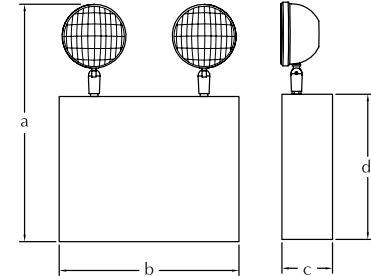

Dimensions are approximate and subject to change.



CC JS Series

EMERGI-LITE

6- and 12-Volt

The CC JS Series is an excellent combination of economy, quality and versatility. Its compact, all-metal housing is offered in a wide variety of battery choices and wattages. The CC JS Series is furnished with our highly reliable PulsePlus charger; Advanced Diagnostics are available as an option.

Listed to UL 924 Standards

Complies with NEC, Life Safety Code and OSHA.

Sealed Maintenance-Free Batteries

- Nickel Cadmium
- Long Life Lead
- Lead Calcium

Diagnostic/Self-Test Feature (optional)

Diagnostic / Self-Test circuitry is optional on all models. This circuitry is programmed to ensure the equipment's readiness and reliability by continuously monitoring every critical function of the unit. If a fault is detected, audible visual indicators isolate the fault, eliminating trouble shooting time. The self-test feature will simulate a power loss for 30 seconds every 30 days with the exception being a full 90-minute test annually.

Outline and Dimensions

Cabinet Size	Dimensions (in.)			
	a	b	c	d
S	11-7/8	11	3-1/2	5-1/4
L	13	12-3/4	4	6-3/8

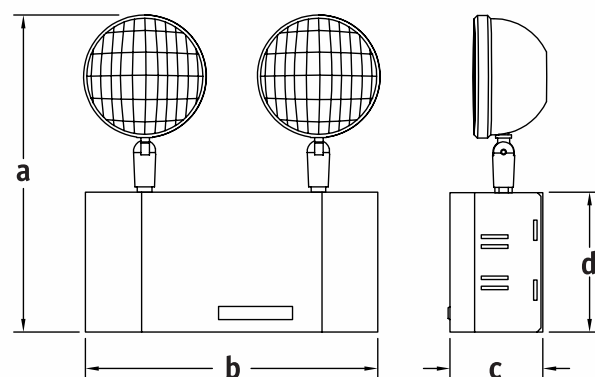

Dimensions are approximate and subject to change.

Options & Accessories

Options (add suffix)

Ammeter or Voltmeter
(choose only one).....-A* or -V*
Advanced Diagnostics-AD
Advanced Diagnostics, Non-Audible-ADNA
Lamp Disconnect Switch-LD
Time Delay
(specify 5, 10 or 15 minutes)-TD**
Automatic Unit Cycler-AUC**
Cord Set - 120-Volt-CP***
Special-Voltage CP (specify plug type).....-XP***
Front Mounted Heads (for low ceilings)-FM
(add prefix)
Black Housing and Heads-B-

Accessories (order as a separate item)

Mounting Bracket (S cabinet)BJ
Wire Guard (S cabinet)WG1
Wire Guard (L cabinet)WG2
Polycarbonate Vandal Resistant Shield (S cabinet)VRS-BB
NEMA 4X Polycarbonate
Vandal Resistant Shield (S cabinet)VRS-BB4X
Wire Guard (front mounted heads)WG10

* Not available with Diagnostics options.

** Not required when using the AD option.

*** Standard cord is 3 ft. Custom lengths available.



Unit Rating Chart

Furnished standard with two EF28 12-watt Sealed Beam Halogen Lamps.

Sealed Maintenance-Free Battery Types	D.C. Volt	Model Number EF28 Lamp Heads	*Watts to 87-1/2% of Rated Battery Voltage				Cabinet Size
			1-1/2 hrs.	2 hrs.	3 hrs.	4 hrs.	
Nickel Cadmium	▲ 6	CCJSC25-2	25	18	12	9	S
	▲ 12	CC12JSC36-2	36	21	15	12	S
	▲ 12	CC12JSC50-2	50	36	25	18	S
Long Life lead	▲ 6	CCJSE27-2	27	16	10	5	S
	▲ 6	CCJSE36-2	36	24	17	13	S
	▲ 6	CCJSE54-2	54	37	28	21	L
	▲ 12	CC12JSE36-2	36	24	17	13	S
	▲ 12	CC12JSE54-2	54	37	28	21	L
	▲ 12	CC12JSM54-2	54	37	28	21	L
Lead Calcium	▲ 6	CCJSM27-2	27	18	14	10	S
	▲ 6	CCJSM36-2	36	25	20	14	S
	▲ 6	CCJSM54-2	54	37	28	21	L
	▲ 12	CC12JSM36-2	36	25	20	14	S
	▲ 12	CC12JSM54-2	54	37	28	21	L

*National Electrical Code Specification ▲ = Advanced Diagnostics Available

How to Order

Example only For standard units without options, order Series, Battery, Watts and Heads only.								Options are added to units by listing suffix at end of model #.	
CC	12	JS	M	36	2	(HJ)*	AD		
City of Chicago Approved Unit	Battery Voltage Blank = 6VDC 12 = 12VDC	Series	Battery Type C = Nickel Cadmium E = Long Life Lead M = Lead Calcium	Watts for 90 min. (See Unit Rating Chart)	Heads 0 = No Heads 1 = One Head 2 = Two Heads	Lamp Type ¹ Blank = 12V, 12W Sealed Beam Halogen, EF28 Heads ² (HJ) = 12V, 12W Bi-Pin Halogen, EF28 Heads (MA) = 12V, 20W, MR16, EF150 Heads ³ (MG) = 12V, 12W, MR16, EF150 Heads ³	See Options Chart.		
								* Do not exceed unit rating in voltage or capacity. 1= See lamp chart on Inside Back Cover for alternate lamps. 2= 6- or 12-volt units supplied with 12-watt sealed beam halogen lamp, PAR36 3= 12-volt units only.	

CC NV Series

CC ILS Series

6- and 12-Volt

The CC NV Series is a reliable, long-life, low maintenance, wet refillable battery unit. This series is designed for maximum battery life and performance during extended run times and offers a wide range of battery capacities.

Listed to UL 924 Standards

Complies with NEC, Life Safety Code and OSHA.

Wet Refillable Batteries

- Wet nickel cadmium batteries are especially suited to environments subject to extreme temperature fluctuations.

6- and 12-Volt

The CC ILS Series is a heavy-duty, conventional emergency lighting unit that is ideally suited for industrial locations. The cabinet front is piano hinged for easy access and provided with a clasp for adding a lock for more security.

Listed to UL 924 Standards

Complies with NEC, Life Safety Code and OSHA.

Sealed Maintenance-Free Batteries

- Nickel Cadmium
- Long Life Lead
- Lead Calcium

Standard Features

- Reliability**
The CC NV Series comes complete with a 3-year full warranty (excluding lamps and pilot lights).
- Unit Data**
Constructed of 18 gauge steel with an off-white, baked enamel finish. Removable front panel with battery view-port. Furnished standard with two EF28 heads with one 12-watt lamp per head. Optional one or three heads available.
Unit and lamp head color is true-white when MR16 lamps are ordered.
- PulsePlus Charger**
PulsePlus circuitry offers 120/277-volt input 60 Hz., 0.3 Amp (other inputs available), fused output circuit(s), dual diagnostic indicator lights, temperature compensation, sealed relay, low voltage battery disconnect, brownout protection and lockout (automatic battery connect).



Outline and Dimensions

Cabinet Size	Dimensions (in.)			
	a	b	c	d
C	19	16-1/2	7-1/4	12-1/4
D	19	27	7-1/4	12-1/4

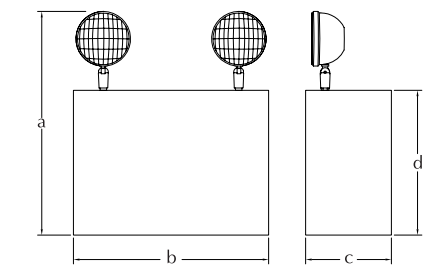

Dimensions are approximate and subject to change.

Options & Accessories

Options (add suffix)

Ammeter or Voltmeter (choose only one).....**A** or **-V**
Lamp Disconnect Switch.....**LD**
Time Delay (specify 5, 10 or 15 minutes).....**TD**
Non-Standard Input Voltage.....Specify
Cord Set - 120-Volt.....**CP**
Cord Set - Special Voltage (specify plug type).....**XP**
Automatic Unit Cycler.....**AUC**

Accessories (order as a separate item)

Mounting Shelf (C cabinet).....**MP6**
Mounting Shelf (D cabinet).....**MP12**
Wire Guard (C cabinet).....**WG3**
Wire Guard (D cabinet).....**WG4**

* Standard cord is 3 ft. Custom lengths available.

Unit Rating Chart

Furnished standard with two EF28 12-watt Sealed Beam Halogen Lamps.

Wet Refillable Battery Types	D.C. Volt	Model Number EF28 Lamp Heads	*Watts to 87-1/2% of Rated Battery Voltage				Cabinet Size
			1-1/2 hrs.	2 hrs.	3 hrs.	4 hrs.	
Nickel Cadmium	6	CCNV81-2	81	70	30	18	C
	6	CCNV125-2	125	100	54	30	C
	6	CCNV163-2	163	126	72	40	C
	12	CC12NV162-2	162	140	60	36	D

*National Electrical Code Specification

How to Order

Example only. For standard units without options, order Series, Battery, Watts and Heads only.						Options are added to units by listing suffix at end of model #.	
CC	12	NV	81	2	—	(HJ)*	V
City of Chicago Approved Unit	Battery Voltage Blank = 6VDC 12 = 12VDC	Series Wet Nickel Cadmium	Watts for 90 min. (See Unit Rating Chart)	Heads 0 = No Heads 1 = One Head 2 = Two Heads 3 = Three Heads		Lamp Type ¹ Blank = 12V, 12W Sealed Beam Halogen, EF28 Heads ² (HJ) = 12, 12W Bi-Pin Halogen, EF28 Heads (MA) = 12V, 20W, MR16, EF150 Heads ³ (MB) = 12V, 35W, MR16, EF150 Heads ³ (MC) = 12V, 50W, MR16, EF150 Heads ³	See Options Chart.
<p>* Do not exceed unit rating in voltage or capacity.</p> <p>1= See lamp chart on Inside Back Cover for alternate lamps.</p> <p>2= 6- or 12-volt units supplied with 12-watt sealed beam halogen lamp, PAR36</p> <p>3= 12-volt units only.</p>							

Standard Features

- Reliability**
The CC ILS Series comes complete with a 3-year full warranty (excluding lamps and pilot lights).
- Unit Data**
Constructed of 18 gauge steel with an ASA61 grey, baked enamel finish, hinged and lockable door. Furnished standard with two black EF28 heads with one 12-watt lamp per head. Optional one or three heads available.
- PulsePlus Charger**
PulsePlus circuitry offers 120/277-volt input 60 Hz., 0.3 Amp (other inputs available), fused output circuit(s), dual diagnostic indicator lights, temperature compensation, sealed relay, low voltage battery disconnect, brownout protection and lockout (automatic battery connect).



Outline and Dimensions

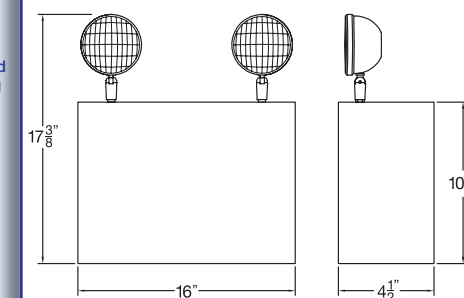

Dimensions are approximate and subject to change.

Options & Accessories

Options (add suffix)

Ammeter or Voltmeter (choose only one).....**A** or **-V**
Advanced Diagnostics.....**AD**
Advanced Diagnostics, Non-Audible.....**ADNA**
Lamp Disconnect Switch.....**LD**
Time Delay (specify 5, 10 or 15 minutes).....**TD**
Automatic Unit Cycler.....**AUC**
Silicone-Coated Circuit Board.....**SPC**
Non-Standard Input Voltage.....Specify
Cord Set - 120-Volt.....**CP**
Cord Set - Special Voltage.....**XP**
(specify plug type)
Off-White Cabinet and Heads.....**OWV**
Special Cabinet Colors.....Specify

Accessories (order as a separate item)

Mounting Bracket.....**B2**
Mounting Shelves (Grey).....**MP3G**
Wire Guard (Cabinet C).....**WG3**

* Not available with Diagnostics options.

** Not required with the AD option.

*** Standard cord is 3 ft. Custom lengths available.

Unit Rating Chart

Furnished standard with two EF28 12-watt Sealed Beam Halogen Lamps.

Sealed Maintenance-Free Battery Types	D.C. Volt	Model Number EF28 Lamps Heads	*Watts to 87-1/2% of Rated Battery Voltage				# of Load Fuses
			1-1/2 hrs.	2 hrs.	3 hrs.	4 hrs.	
Nickel Cadmium	6	CCILSC25-2	25	18	9	-	1
	12	CC12ILSC36-2	36	21	12	6	1
	12	CC12ILSC50-2	50	36	18	10	1
	6	CCILSE27-2	27	16	10	5	1
Long Life Lead	6	CCILSE36-2	36	24	13	7	1
	6	CCILSE42-2	54	36	20	11	1
	6	CCILSE80-2	80	65	35	19	2
	6	CCILSE110-2	110	72	40	24	2
	12	CC12ILSE36-2	36	24	13	7	1
	12	CC12ILSE54-2	54	37	21	10	2
Lead Calcium	12	CC12ILSE110-2	110	74	43	21	2
	6	CCILSM27-2	27	18	10	6	1
	6	CCILSM36-2	36	25	14	7	1
	6	CCILSM54-2	54	37	21	12	1
	6	CCILSM81-2	81	54	36	18	2
	6	CCILSM110-2	110	72	40	24	2
	12	CC12ILSM36-2	36	25	14	7	1
	12	CC12ILSM54-2	54	37	21	12	1
	12	CC12ILSM110-2	110	72	40	24	2

*National Electrical Code Specification ▲ = Advanced Diagnostics Available

How to Order

Example only. For standard units without options, order Series, Battery, Watts and Heads only.									
CC	12	ILS	M	36	2	(HJ)*	AD	Options are added to units by listing suffix at end of model #.	
City of Chicago Approved Unit	Battery Voltage Blank = 6VDC 12 = 12VDC	Series	Battery Type C = Nickel Cadmium E = Long Life Lead M = Lead Calcium	Watts for 90 min. (See Unit Rating Chart)	Heads 0 = No Heads 1 = One Head 2 = Two Heads 3 = Three Heads	Lamp Type ¹ Blank = 12V, 12W Sealed Beam Halogen, EF28 Heads ² (HJ) = 12V, 12W Bi-Pin Halogen, EF28 Heads	See Options Chart.		

* Do not exceed unit rating in voltage or capacity.

1= See lamp chart on Inside Back Cover for alternate lamps.

2= 6- or 12-volt units supplied with 12-watt sealed beam halogen lamp, PAR36



CC KS Series

Remote Heads

6- and 12-Volt

Harsh Environment Enclosure

The CC KS Series is designed to protect circuitry and connections from harmful dust, liquids and atmospheric contaminants.

Listed to UL 924 Standards

Complies with NEC, Life Safety Code and OSHA.

Sealed Maintenance-Free Batteries

- Nickel Cadmium
- Long Life Lead
- Lead Calcium

CC EF28 & CC EF150 Series

Remote Emergency Lighting Fixtures

A multi-purpose, surface-type remote fixture the CC EF28 Series is ideally suited for most commercial applications.

For interiors where aesthetics are a priority, the Distinction™ CC EF150 Series combines contemporary styling with the ultra efficiency of MR16 halogen lamps.

Listed to UL 924 Standards

Complies with NEC, Life Safety Code and OSHA.



Standard Features

- **Reliability**
The CC EF28 and EF150 Series come complete with a 3-year warranty (excluding lamps).
- **Unit Data**
CC EF28

All metal construction remote head fixture with fully adjustable swivel. Available as a single, double or triple head fixture. Standard finish is chrome. Off-white or black available as an option. PAR36 sealed beam, PAR36 sealed beam halogen, and Bi-Pin halogen lamps are available. Available with lamp series H, U, X.

CC EF150
Die-cast aluminum construction with resistant epoxy powder-coated finish. Available in 1-, 2- or 3- head configurations in white or black. Light source is MR16 halogen lamps. In 12-, 20-, 35- or 50- watts.



Outline and Dimensions

Dimensions are approximate and subject to change.

Standard Features

- **Reliability**
The CC KS Series comes complete with a 3-year full warranty (excluding lamps and pilot lights).
- **Unit Data**
Constructed of 14 gauge steel with a fully gasketed hinged door and separate battery compartment. It is finished with a gray baked epoxy enamel. Up to three EF28 heads can be mounted on the enclosure.
- **PulsePlus Charger**
PulsePlus circuitry offers 120/277-volt input 60 Hz., 0.3 Amp (other inputs available), fused output circuit(s), dual diagnostic indicator lights, temperature compensation, sealed relay, low voltage battery disconnect, brownout protection and lockout (automatic battery connect).



Outline and Dimensions

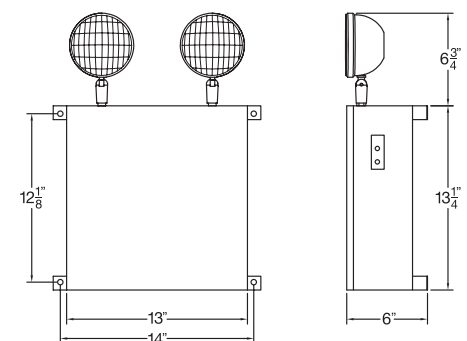

Dimensions are approximate and subject to change.

Options & Accessories

Options (add suffix)

Advanced Diagnostics	-AD
Advanced Diagnostics, Non-Audible	-ADNA
Lamp Disconnect Switch	-LD
Time Delay (Specify 5, 10 or 15 minutes)	-TD*
Cord and Plug - Special-Voltage (specify plug type)	-XP**

* Not required when using the AD option.
** Standard cord is 3 ft. Custom lengths available.

Unit Rating Chart

Furnished standard with two EF28 12-watt Sealed Beam Halogen Lamps.

Sealed Maintenance-Free Battery Types		D.C. Volt	Model Number EF28 Lamps Heads	*Watts to 87-1/2% of Rated Battery Voltage			
				1-1/2 hrs.	2 hrs.	3 hrs.	4 hrs.
Nickel Cadmium	▲	6	CCKSC25-2	25	18	9	5
	▲	12	CC12KSC36-2	36	21	12	6
	▲	12	CC12KSC50-2	50	36	18	10
Long Life Lead	▲	6	CCKSE27-2	27	19	10	5
	▲	6	CCKSE36-2	36	24	13	7
	▲	6	CCKSE54-2	54	36	20	11
	▲	6	CCKSE80-2	80	65	35	19
	▲	6	CCKSE110-2	110	74	43	21
	▲	12	CC12KSE36-2	36	24	13	7
	▲	12	CC12KSE54-2	54	37	21	10
	▲	12	CC12KSE110-2	110	74	43	21
	▲	6	CCKSM27-2	27	18	10	6
Lead Calcium	▲	6	CCKSM54-2	54	37	21	12
	▲	6	CCKSM81-2	81	54	30	18
	▲	6	CCKSM110-2	110	72	40	24
	▲	12	CC12KSM54-2	54	37	21	12
	▲	12	CC12KSM110-2	110	72	40	24

*National Electrical Code Specification ▲ = Advanced Diagnostics Available

How to Order

Example only.
For standard units without options, order Series, Battery, Watts and Heads only.

Options are added to units by listing suffix at end of model #.

CC	12	KS	M	36	2	(HJ)*	AD
City of Chicago Approved Unit	Battery Voltage Blank = 6VDC 12 = 12VDC	Series	Battery Type C = Nickel Cadmium E = Long Life Lead M = Lead Calcium	Watts for 90 min. (See Unit Rating Chart)	Heads 0 = No Heads 1 = One Head 2 = Two Heads 3 = Three Heads	Lamp Type ¹ Blank = 12V, 12W Sealed Beam Halogen, EF28 Heads ² (HJ) = 12V, 12W Bi-Pin Halogen, EF28 Heads	See Options Chart.

* Do not exceed unit rating in voltage or capacity.
1= See lamp chart on Inside Back Cover for alternate lamps.
2= 6- or 12-volt units supplied with 12-watt sealed beam halogen lamp, PAR36

How to Order

Example only.

CC	EF28	XD	OW
City of Chicago Approved	Series	Lamp Designator*	Options
	EF28 = One Head EF28D = Two Heads EF28T = Three Heads	(XD)	OW = Off-White BK = Black

* See lamp chart on Inside Back Cover for alternate lamps.

CC	EF150	B	MA
City of Chicago Approved	Series	Color	Wattage
	EF150 = One Head EF150D = Two Heads EF150T = Three Heads	Blank = White B = Black	(MA) = 20 Watts (MB) = 35 Watts (MC) = 50 Watts (MG) = 12 Watts

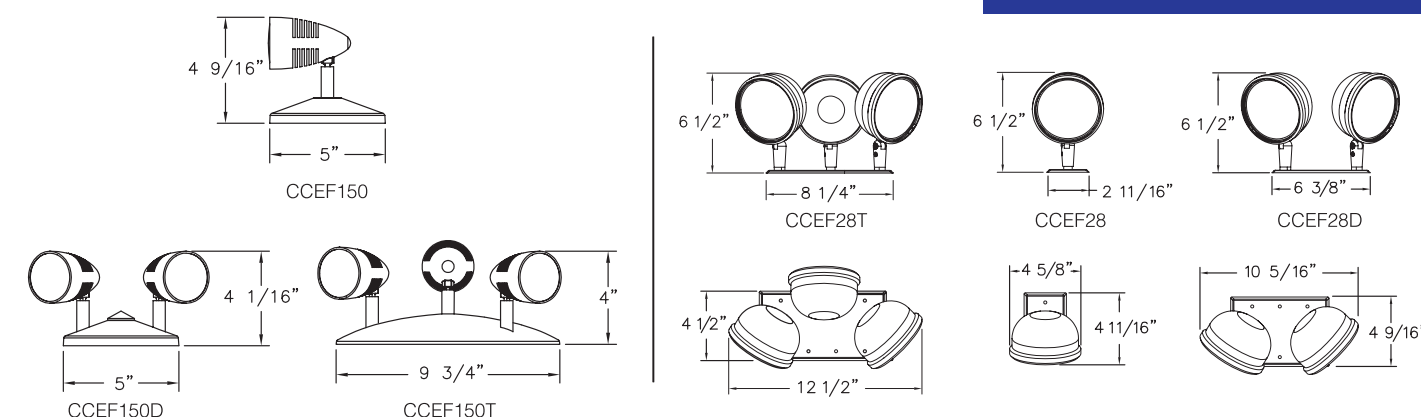

Dimensions are approximate and subject to change.



X10 Series

EMERGI-LITE

Steel, Fully Universal Exit Signs

The Chicago approved X10 Series is a rugged steel exit sign designed for ease of installation. A fully universal exit, it is available in AC-Only, AC/DC and self-powered models. The removable side panel provides job site flexibility in changing signs for either single or double face requirements.

Listed to UL 924 Standards

Exceeds UL Exit Visibility Requirement

Light Sources

Incandescent
Fluorescent

Sealed Maintenance-Free Batteries

Long Life Lead, rated for a minimum 2-hour run time.

Standard Features

- Reliability**
The X10 Series comes complete with a 3-year full warranty (excluding lamps and pilot lights).
- Unit Data**
Rugged 20 gauge steel housing available in off-white or black finish. Screened glass panel of red letters on a white background.
- PulsePlus Charger**
PulsePlus circuitry offers 120/277-volt input 60 Hz. (other inputs available), fused output circuit, dual diagnostic indicator lights, temperature compensation, sealed relay, low voltage battery disconnect, brownout protection and lockout (automatic battery connect).

Outline and Dimensions

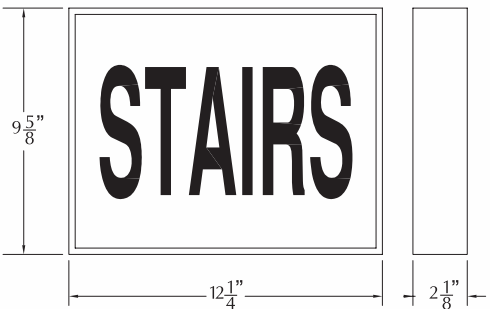
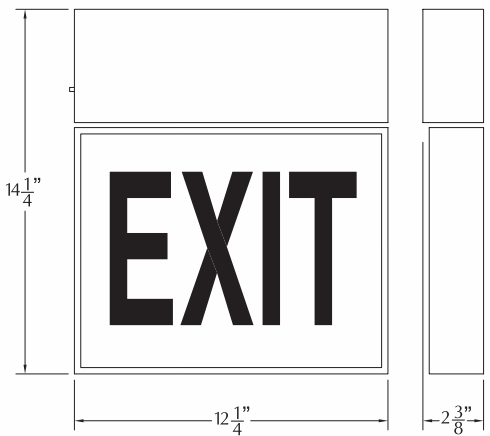

Dimensions are approximate and subject to change.

High Performance Circuitry

- The AC line-catch circuit allows battery connections to be made prior to energizing the AC circuit to the sign, thus minimizing installation labor.
- Fully automatic charger is solid state.
- Sealed, maintenance-free long life lead battery provides 120 minutes of emergency operation.
- Batteries recharge per UL requirements.
- Instantaneous transfer to the emergency mode by means of a sealed, dust-tight transfer relay.

Options & Accessories

Options (add suffix)
Pulse Plus Diagnostics-PPD
(add prefix)
PL7 Lamps (AC-Only units)PL-

Accessories (order as separate item)
Pendant 12" White P12WT
Pendant 12" Black P12BK
Wireguard – AC-Only End or Ceiling Mount.. WG5
Wireguard – AC-Only Wall Mount..... WG12
Wireguard – Self-Powered Wall Mount WG2

How to Order

AC-Only						
	W	X12	RW	#3		
DC Lamp Option	Housing Color	Series, Number of Faces	Letter/Face Color	Chicago Code	AC Input	Options
Blank = AC-Only 6 = 6VDC 12 = 12VDC	W = White B = Black	X12 = Single Face, Wall Mount X13 = Double Face, End or Ceiling Mount	RW = Red Letters/ White Face	Description Single Face Double Face	Blank = 120 VAC 277 = 277 VAC	See Options Chart.
				Stairs, No Arrow #2A	#17A	
				Exit, No Arrow #3	#18	
				Stairs Arrow Right #5A	-	
				Exit, Arrow Right #6	-	
				Stairs, Arrow Left #8A	-	
				Exit, Arrow Left #9	-	
				Stairs, Double Arrow #11A	#23A	
				Exit, Double Arrow #12	#24	
				Stairs, Arrow Right and Left ...-	#20A	
				Exit, Arrow Right and Left-	#21	

Self-Powered						
PL	W	SRX12	RW	#3		
Lamp Type	Housing Color	Series, Number of Faces	Letter/Face Color	Chicago Code	Options	
Blank = Incandescent PL = Fluorescent	W = White B = Black	SRX12 = Single Face, Wall Mount SRX13 = Double Face, End or Ceiling Mount	RW = Red Letters/ White Face	Description Single Face Double Face	See Options Chart.	
				Stairs, No Arrow #2A	#17A	
				Exit, No Arrow #3	#18	
				Stairs Arrow Right #5A	-	
				Exit, Arrow Right #6	-	
				Stairs, Arrow Left #8A	-	
				Exit, Arrow Left #9	-	
				Stairs, Double Arrow #11A	#23A	
				Exit, Double Arrow #12	#24	
				Stairs, Arrow Right and Left ...-	#20A	
				Exit, Arrow Right and Left-	#21	



Prestige Series

Premium Cold-Cathode, Edge-Lit Fluorescent Exit Signs

The Prestige™ CC LX, CC LXN Series combines the performance of cold-cathode fluorescent lamps and the light-transmitting characteristics of thin, computer-engraved virgin acrylic panels to provide maximum illumination in an attractive and unobtrusive design.

Listed to UL 924 Standards

Complies with NEC, Life Safety Code and OSHA. CCEA Approved.

Light Source

Twin Cold-Cathode Fluorescent Lamps

Sealed Maintenance-Free Batteries

Nickel Cadmium
(6-volt, minimum 2-hour illumination)

Standard Features

- Reliability

The Prestige™ CC LX, CC LXN Series has a 3-year warranty (excluding lamps and pilot lights). Cold-cathode fluorescent lamps have a 3-year life expectancy.

- Unit Data

Housing

Die-cast aluminum housing, trim ring, trim plate and canopy. Standard finish is brushed aluminum with other finishes available as an option.

Face Plate

Virgin acrylic face plate is 3/8" thin, silk-screened and computer-engraved to provide a flawless legend. Face plates are available with red letters on a white panel (single or double face).

Servicing

The trim plate assembly is hinged to provide easy access to the lamps, electronics and battery.

- Circuitry

The two cold-cathode fluorescent lamps are driven independently by their own fused inverter/ballast circuits. This feature allows the sign to remain illuminated should a lamp or the driver circuit expire. Optional self-testing diagnostics are available on all self-powered models.

Electrical Characteristics

- Power requirements: 120/277 VAC, 60 Hz.
- Transfer: solid state relay automatically and instantly transfers lamp load upon failure of AC supply.
- Brownout: close tolerance electronic circuit activates emergency unit when utility power dips below nominal voltage.
- Charger: current limited and short circuit proof. Charger regulation ±1%. The equipment is capable of full recharge in compliance with UL 924 specifications.
- Controls: Combination push button test switch and LED AC indicator light.

Diagnostic/Self Test Feature (optional)

Diagnostic / Self Test circuitry is optional on all self-powered models. This circuitry is programmed to ensure the exits readiness and reliability by continuously monitoring every critical function of the unit. If a problem occurs, a single FAULT indicator illuminates immediately. A detailed diagnostic display is located on the inside of the exit sign, out of sight from the general public. The detailed diagnostic display inside the exit sign will further indicate the nature of the fault. The self test will test the unit for 30 seconds every 30 days, 30 minutes every 60 days and 90 minutes annually.

Input AC Voltage	Frequency (in Hertz)	Power Consumption (in Watts)		Power Factor
		AC-Only	Self-Powered	
120	60	8.4	9.8	0.85
277	60	8.5	9.9	0.86

Mounting Configuration

All mounting configurations use the same basic components. Inserting a trim ring allows for recessed mounting on walls or ceilings. Applying a canopy allows for surface mounting on ceilings or walls as back or end mount.



Options & Accessories

Options (add suffix)

Dual Circuit Operation (AC-only)2CKT
Fire Alarm Activated FlasherFA
Flasher/Buzzer (self-powered only)FZ
Self Testing/Diagnostic (self-powered only)D

Accessories (order as a separate item)

Replacement Lamp Assembly061903
12" White Pendant.....P12WT
12" Black Pendant.....P12BK
12" Brushed Aluminum PendantP12AL
12" Chrome PendantP12CH
12" Bronze PendantP12BZ
Custom pendant lengths available.

Outline and Dimensions

Recessed Models

Wall Mount

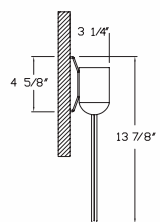

Ceiling Mount

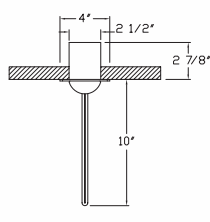

Surface Models

Wall Mount

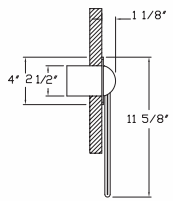

Ceiling Mount

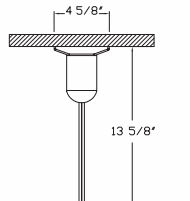

End Mount

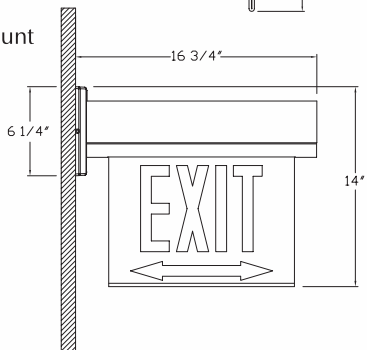

Dimensions are approximate and subject to change.

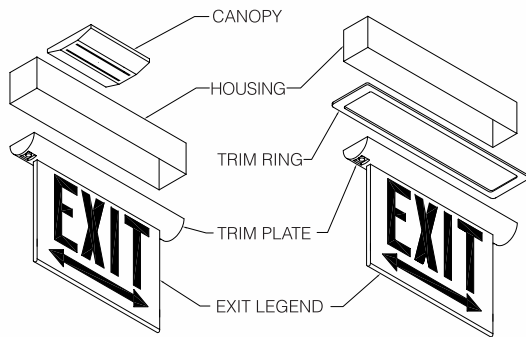

SURFACE MOUNT

RECESSED MOUNT

How to Order

Example only.									
W	CC	LX	RW	#2A	C	U	2 CKT		
Color	Cold-Cathode Fluorescent Lamps	Model	Letter/Background Color	Chicago Code	Trim Plate	Model	Options		
Blank = Brushed Aluminum W = White B = Black BR = Dark Bronze PB = Polished Brass CH = Polished Chrome		LX = AC-Only LXN = Self-powered	RW = Red/White	Description Stairs, No Arrow#2A Exit, No Arrow#3 Stairs Arrow Right#5A Exit, Arrow Right#6 Stairs, Arrow Left#8A Exit, Arrow Left#9 Stairs, Double Arrow#11A Exit, Double Arrow#12 Stairs, Arrow Right and Left ...- Exit, Arrow Right and Left ...-	Single Face #17A #18 - - - - #23A #24 #20A #21	Double Face C=Circular Standard A= Angular Optional	U= Universal Mounting	See Options Chart.	



Wiring Size Guide

Determining Wire Size

The following information is provided to assist in designing proper emergency lighting systems effectively and economically by using the smallest permissible wire size for load circuits. When remote lighting fixtures and/or exit signs are connected to emergency lighting units, circuit runs must be of sufficient size to maintain a proper operating voltage to all lamps. The National Electrical Code limits voltage to drop to a maximum of 5% of nominal. The table below gives the maximum length or wire run based on systems voltage, wire gauge and total wattage on the run.

To determine the maximum length of a wire run not listed, divide the value of the load in watts into the constant listed at the bottom of each row. Example, the maximum wire run for #10 wire on a 12 volt system, with a 54 watt load, is $3397 \div 54$ or, or 62 feet.

Conversely, to determine the maximum load on a run of known length, divide the length into the constant. Example, a 36 foot run of #12 wire on a 6 volt systems can be loaded to, $534 \div 36$, or 14 watts; on #10 wire, 23 watts.

Specification Flexibility

Total watts on wire run	WIRING DISTANCE IN FEET (Maximum Voltage Drop 5%)													
	6 volt wire size				12 volt wire size					24 volt wire size				
	#12	#10	#8	#6	#12	#10	#8	#6	#4	#12	#10	#8	#6	#4
6	89	141	225	357	356	566	900	1431	+	1425	+	+	+	+
8	66	106	168	268	267	424	675	1073	1707	1068	1698	+	+	+
9	59	94	150	238	237	377	600	954	1517	949	1509	+	+	+
10	53	84	135	214	213	339	540	859	1366	854	1358	+	+	+
12	44	70	112	178	178	283	450	715	1138	712	1132	1801	+	+
16	33	53	84	134	133	212	337	536	853	534	849	1350	+	+
18	29	47	75	119	118	188	300	477	758	474	754	1200	1909	+
24	22	35	56	89	89	141	225	357	569	356	566	900	1431	+
25	21	33	54	85	85	135	216	343	546	341	543	864	1374	+
27	19	31	50	79	79	125	200	318	505	316	503	800	1272	+
30	17	28	45	71	71	113	180	286	455	284	452	720	1145	1821
36	14	23	37	59	59	94	150	238	379	237	377	600	954	1517
42	12	20	32	51	50	80	128	204	325	203	323	514	818	1300
45	11	18	30	47	47	75	120	190	303	189	301	480	763	1214
48	11	17	28	44	44	70	112	178	284	178	283	450	715	1138
50	10	16	27	42	42	67	108	171	273	170	271	432	687	1092
75	7	11	18	28	28	45	72	114	182	113	181	288	458	728
100	5	8	13	21	21	33	54	85	136	85	135	216	343	546
150	—	5	9	14	14	22	36	57	91	56	90	144	229	364
200	—	—	6	10	10	16	27	42	68	42	67	108	171	273
250	—	—	5	8	8	13	21	34	54	34	54	86	137	218
300	—	—	—	7	7	11	18	28	45	28	45	72	114	182
400	—	—	—	5	5	8	13	21	34	21	33	54	85	136
500	—	—	—	—	—	6	10	17	27	17	27	43	68	109
Constant	534	849	1350	2148	2137	3397	5403	8590	13660	8548	13588	21613	34363	54641

Longer Wire Runs

The wiring distances give the maximum length of a battery circuit, assuming that the entire load is concentrated at the end of the circuit. If loads are uniformly spaced along the circuit path (equal watts, equal distances), the lengths in the table may be increased, based on number of fixtures on a given circuit, by means of the chart and formula below.

Number of Fixtures	2	3	4	5	6	N
Multiply Feet By	1.33	1.5	1.6	1.67	1.71	$2n/(n+1)$

For example, a 36 foot long, 6 volt circuit has (3) 9 watt heads spaced 12 feet apart. According to the wire run table, # 8 wire must be used (at 50 feet for a 5% voltage drop.) but, by multiplying the 31 feet for #10 wire by 1.5, a 46 1/2 foot wire run is acceptable, so #10 wire may be used and still meet the 5% voltage drop limitation.

Note: Smallest permissible wire size for systems under 50 volts is #12 wire for emergency lighting equipment under Article 720-4 of the National Electrical Code.

Popular Options

Emergi-Lite life safety equipment is available with a range of options that can be added to enhance performance, simplify testing or adapt equipment for use in specific environments.

Please refer to individual product pages to verify availability of individual options on specific equipment.

PTS (Photoelectric Test Switch)

option allows maintenance personnel to manually test difficult to access emergency lighting equipment. When a conventional spotbeam flashlight (not supplied) is aimed at the PTS sensor located on the bottom of the unit, the unit will transfer into emergency operation. Depending on the intensity of the flashlight, testing can be accomplished at distances of up to 30 feet away.

Add Suffix: -PTS

Voltmeter

option provides a visual indication, in the test mode, of the unit's battery voltage. The good/check meter face allows maintenance personnel to recognize charger and battery function.

Add Suffix: -V

Ammeter

option provides an indication of charge current when the unit is in the equalize mode. This verifies charger capability and the current acceptance of the battery.

Add Suffix: -A

Automatic Unit Cycler

option is designed to self-test an emergency lighting unit at 30 day intervals. An internal digital counter precisely times out 30 days, whereupon the unit is then placed into a simulated power failure condition for 30 minutes, thus providing a long duration visible test and exercise of the battery. The unit is field resettable to any particular day desired for 30 day testing.

Add Suffix: -AUC

Time Delay

option is designed to be used in areas where mercury vapor or HID type lamps are used for normal lighting. As these lamps require several minutes to restrike and to produce their nominal lighting output, it is necessary to also hold the emergency lighting on for this period, even after the AC utility has been restored. The TD board is available in durations of 5, 10 and 15 minutes (must specify).

Also, in areas where it is difficult to directly access an emergency lighting unit's test switch, a time delay unit can be helpful. The power to the unit can be briefly switched off and on at the breaker panel, and the maintenance person can then return to the unit and observe a timed emergency operation.

Add Suffix: -TD (Specify Time)

Silicone Coated Circuit Board

is designed to be used in areas where either high humidity, corrosive chemicals, or gases are present. The silicone encapsulation properties assure that the printed circuit board will not be damaged in the above environments.

Add Suffix: -SPC

Advanced Diagnostics

see page 20.





EMERGI-LITE Advanced Diagnostics

Our Advanced Diagnostics was designed to continuously monitor every critical function of the unit, attached remote lighting heads and exit signs. Operational status is indicated by colored LED lamps. A high-pitch audible alarm and an LED status indicator alert maintenance personnel of a unit malfunction. This option saves the time spent on testing and trouble shooting by maintenance personnel. This new generation of Emergi-Lite diagnostics is perfect for any application.

Diagnostic Functions

- Battery Failure**
LED will illuminate when battery is shorted or battery voltage drops below an acceptable value.
- Battery Disconnect**
LED will illuminate if the battery circuit is open.
- Charger Failure**
LED will illuminate when charger is not functioning properly. Charge current is continuously monitored.
- Lamp Failure**
LED will illuminate to indicate a bad lamp or faulty circuit.
- Service Alarm**
LED will illuminate when there is a fault with the unit and the unit must be serviced.
- AC ON**
LED will illuminate when AC power is present.
- Charger ON**
LED will illuminate when charger is supplying charge current to the battery.
- Alarm Silence/Test Button**
Switch is used to acknowledge and silence the alarm. Once silenced, the LED indicators will flash until the fault is corrected. The button also serves as a manual test button to simulate a power failure.

Field Programmable, On Board Features

- Automatic Unit Test.**
This feature can be activated so that every 30 days the unit will transfer to the emergency mode for 15 minutes.
- Transfer Time Delay.**
When activated, this feature will keep the emergency lights on for a period of 10 minutes after the AC power is restored.

Diagnostic Functions

Audible and non-audible versions now available (ADNA), compatible with lead calcium and nickel cadmium batteries

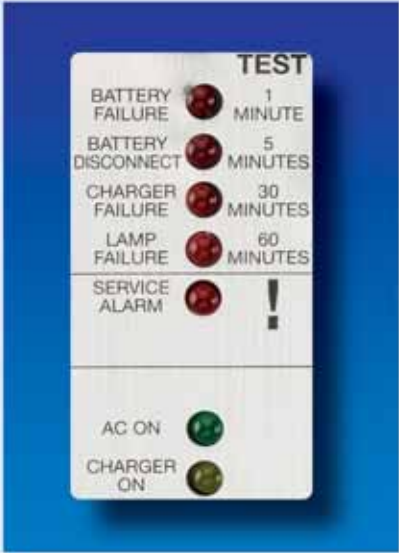

Lamp Chart

Lamp Type	Catalog Suffix	Voltage	Watts	Lumens
Bi-Pin Halogen	HE	6	20	402
	HJ	12	12	300
PAR36 Sealed Beam Halogen	XD	6	12	227
	XE	6	20	382
	XG	12	12	262
	XH	12	37	756
PAR36 Sealed Beam	UC	6	25	385
	UD	6	30	460
	UG	12	25	395
	UH	12	30	460
MR16				Center Beam Candle Power
	MG	12	12	400
	MA	12	20	600
	MB	12	35	1500
	MC	12	50	2200